

DPMH-Exe 金属增安六角闷盖

材 料: 黄铜镀镍

防爆等级: Exe II C Gb DIP A21

温 度: -50℃—+150℃

应用场合: 对预留孔进行密封, 为系统扩展提供便捷

更多选择: 可提供加长螺纹,

供货周期: 备有大量现货, 特大量需确认

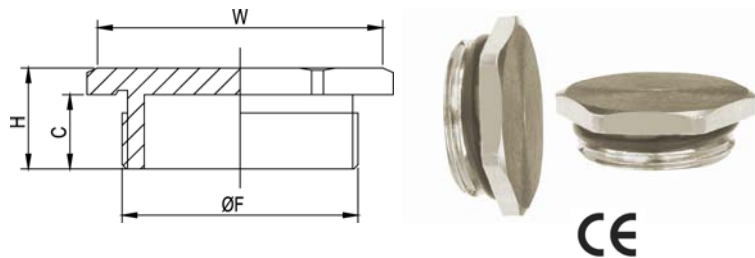

DPMH-Exe-GM x1.5/2.0 国标公制螺纹

螺纹标准: GB/T192-2003 GB/T196-2003

规格	螺纹外 径 F	螺纹 长度 C	对边尺寸 SW	单位 包装	六角 订货编号	螺纹 长度 C	六角 订货编号
M12x1.5	12	6	14	50	4635.012.009	15	4635.012.019
M14x1.5	14	7	18	50	4635.014.009	15	4635.014.019
M16x1.5	16	7	18	50	4635.016.009	15	4635.016.019
M18x1.5	18	7	20	50	4635.018.009	15	4635.018.019
M20x1.5	20	7	22	50	4635.020.009	15	4635.020.019
M22x1.5	22	7	24	50	4635.022.009	15	4635.022.019
M24x1.5	24	7	27	50	4635.024.009	15	4635.024.019
M26x1.5	26	7	30	50	4635.026.009	15	4635.026.019
M27x2.0	27	7	30	50	4635.027.009	15	4635.027.019
M30x2.0	30	8	32	20	4635.030.009	15	4635.030.019
M33x2.0	33	8	36	20	4635.033.009	15	4635.033.019
M36x2.0	36	8	40	10	4635.036.009	15	4635.036.019
M42x2.0	42	8	45	10	4635.042.009	20	4635.042.019
M44x2.0	44	9	50	10	4635.044.009	20	4635.044.019
M48x2.0	48	9	50	10	4635.048.009	20	4635.048.019
M56x2.0	56	9	60	10	4635.056.009	20	4635.056.019
M60x2.0	60	10	65	10	4635.060.009	20	4635.060.019
M64x2.0	64	10	67	5	4635.064.009	20	4635.064.019
M72x2.0	72	10	75	5	4635.072.009	20	4635.072.019
M80x2.0	80	15	90	1	4635.080.009	25	4635.080.019
M90x2.0	90	15	100	1	4635.090.009	25	4635.090.019
M100x2.0	100	15	110	1	4635.100.009	25	4635.100.019
M110x2.0	110	15	120	1	4635.110.009	25	4635.110.019
M120x2.0	120	15	130	1	4635.120.009	25	4635.120.019
M150x2.0	150	15	160	1	4635.150.009	25	4635.150.019

DPMH-Exe 金属增安六角闷盖

材 料: 黄铜镀镍

防爆等级: Exe II C Gb DIP A21

温 度: -50℃—+150℃

应用场合: 对预留孔进行密封, 为系统扩展提供便捷

更多选择: 可提供加长螺纹,

供货周期: 备有大量现货, 特大量需确认

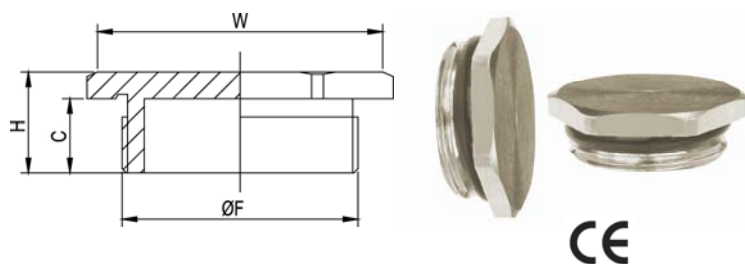

DPMH-Exe-M x1.5 欧洲公制螺纹

螺纹标准: EN60423

规格	螺纹外 径 F	螺纹 长度 C	对边尺寸 SW	H	单位 包装	六角 订货编号	螺纹 长度 C	六角 订货编号
M12x1.5	12	6	14	9	50	4635.012.009	15	4635.012.019
M16x1.5	16	7	18	9	50	4635.016.009	15	4635.016.019
M20x1.5	20	7	22	10	50	4635.020.009	15	4635.020.019
M25x1.5	25	7	27	10.5	50	4635.025.009	15	4635.025.019
M32x1.5	32	8	34	12	50	4635.032.009	15	4635.032.019
M40x1.5	40	8	45	12.5	50	4635.040.009	20	4635.040.019
M50x1.5	50	9	55	14	20	4635.050.009	20	4635.050.019
M63x1.5	63	10	65	15	10	4635.063.009	20	4635.063.019

DPMH-Exe-G G 管螺纹螺纹

螺纹标准: JIS B0204 / ISO228-1 管螺纹

规格	螺纹外 径 F	螺纹 长度 C	对边尺寸 SW	H	单位 包装	六角 订货编号	加长 螺纹	六角 订货编号
G1/4"	12.99	5	18	8	50	4635.302.009	15	4635.302.019
G1/2"	20.99	7	24	10	50	4635.304.009	15	4635.304.019
G3/4"	26.44	7	30	10.5	25	4635.306.009	15	4635.306.019
G1"	33.25	8	36	12	25	4635.308.009	15	4635.308.019
G1-1/4"	41.91	8	45	12.5	20	4635.310.009	15	4635.310.019
G1-1/2"	47.80	9	50	14	20	4635.312.009	15	4635.312.019
G2"	59.61	10	65	15	5	4635.316.009	15	4635.316.019
G3"	87.88	15	100	22	5	4635.324.009	20	4635.324.019
G4"	113.03	20	120	26	5	4635.332.009	25	4635.332.019

DPMH-Exe 金属增安六角闷盖

材料: 黄铜镀镍
 防爆等级: Exe II C Gb DIP A21
 温度: -40℃—+150℃
 应用场合: 对预留孔进行密封, 为系统扩展提供便捷
 更多选择: 可提供加长螺纹,
 供货周期: 备有大量现货, 特大量需确认

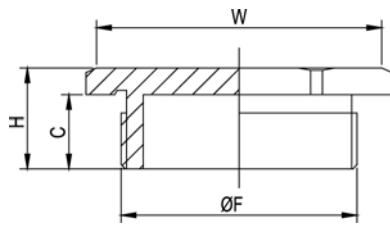

DPMH-Exe-N NPT 制锥形螺纹

螺纹标准: ANSI 1.20.1

规格 型号	螺纹 外径 F	螺纹 长 C	对边尺寸 SW	单位 包装	订货编号
NPT3/8"	17.055	10.3	18	50	4635.203.009
NPT1/2"	21.224	13.6	24	50	4635.204.009
NPT3/4"	26.569	14.1	30	25	4635.206.009
NPT1"	33.227	16.8	36	20	4635.208.009
NPT1"1/4"	41.984	17.3	45	10	4635.210.009
NPT1"1/2"	48.053	17.3	50	10	4635.212.009
NPT2"	60.091	17.7	65	10	4635.216.009
NPT2 1/2"	72.699	23.68	75	1	4635.218.009
NPT 3"	88.608	25.81	100	1	4635.224.009
NPT4"	113.97	27.78	120	1	4635.232.009

** 订货前请咨询供货周期

DPMH-Exe-P 德国 PG 螺纹

螺纹标准: DIN40430

规格	螺纹外 径 F	螺纹 长度 C	扳手 SW	单位 包装	六角 订货编号	加长 螺纹	六角 订货编号
Pg7	12.5	5	14	50	4635.107.009	15	4635.107.019
Pg9	15.2	6	18	50	4635.109.009	15	4635.109.019
Pg11	18.6	7	20	50	4635.111.109	15	4635.111.119
Pg13.5	20.4	7	22	50	4635.113.009	15	4635.113.019
Pg16	22.5	7	24	50	4635.116.009	15	4635.116.019
Pg21	28.3	7	30	50	4635.121.009	15	4635.121.019
Pg29	37.0	8	40	20	4635.129.009	15	4635.129.019
Pg36	47.0	9	50	10	4635.136.009	15	4635.136.019
Pg42	54.0	10	60	10	4635.142.009	15	4635.142.019
Pg48	59.3	10	65	10	4635.148.009	15	4635.148.019